



KASPER GROUP

WWW.KASPERGROUP.CZ



THE KASPER GROUP CONSISTS OF

KASPER KOVO s.r.o.

KASPER CZ s.r.o.

KASPER POLSKA Sp. Z o.o.

KASPER SK s.r.o.

KASPER TS s.r.o.



WE LOOK TO THE FUTURE

The KASPER brand name first arrived on the market in 1990. Our family business specialises in selected segments of the construction and engineering industries, where our goal is to be a first-rate and highly competitive company.

We have gained a large number of satisfied and loyal customers both in the Czech Republic and many other countries. Customer loyalty is something that we value highly, which is why satisfied customers will remain our top priority in further stages of our development.

We could not achieve our success without a team of skilled and motivated co-workers. Great emphasis is placed on staff training – we run our own welding school, and ensure language lessons and professional training.

We have a deep relationship with and feel responsible towards the Krkonoše Mountain region, which we support in the areas of education, culture, art, sport and the environment.

As long as we continue to honour our business principles, I am convinced that a future full of growth and prosperity is ahead of us.

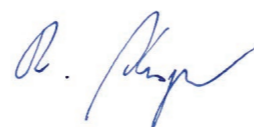

Ing. Rudolf Kasper,
Managing Director

KASPER KOVO S.R.O.

Business premises
Žitná

Žitná 476
541 03 Trutnov 3



KASPER KOVO S.R.O.

Business premises
Elektrářenská

Elektrářenská 322
541 03 Trutnov 3



KASPER CZ S.R.O.

Ječná 550
541 03 Trutnov 3



SHEET METAL PRODUCTS IN THE STARRING ROLE



Ing. Jakub Kasper,
CEO

KASPER KOVO S.R.O.

ADDRESS: Žitná 476
541 03 Trutnov 3

TEL: +420 499 827 111
FAX: +420 499 827 115
E-MAIL: info@kasperkovo.cz

COMPANY ID: 46508465
TAX ID: CZ46508465
WEB: www.kasperkovo.cz

The company KASPER KOVO s.r.o. was founded in 1992. Today, it is represented by two production plants situated in Trutnov (the Žitná Street and Elektrárnská Street plants). The parent plant on Žitná Street is a modern engineering plant that specialises in small-batch production of products ranging from sheet metal components to comprehensive machinery, including final assembly. The demands on logistics and production flexibility in this line of work are very high. The production management system is adapted to these requirements in order to meet the highest customer demands in terms of quality and supply flexibility.

The Company's technological equipment meets the highest modern standards for sheet metal processing, from material cutting and welding to surface finishing. In order to make full use of these modern technologies, the Company also ensures ongoing staff training and continuous improvement of its processes to ensure that the customer receives the best quality-to-price ratio. In terms of technology and internal production logistics, processing of noble metals (stainless steel and aluminium) is separated from production using ordinary steel in order to meet the strictest requirements of the food and pharmaceutical industries.

The Žitná Street sheet metal processing plant provides a very wide range of products and services in order to fully meet the requirements of a wide portfolio of customers from diverse industries. Its products therefore range from sheet metal components to weldments and fully assembled machines. Services relating to product development and cost optimisation, as well as the provision of complete logistics around the world, are a matter of course. Our products are primarily used in the following sectors: the food industry, bus production, machine tool production, air filtration and the power engineering industry.

They are sent to customers throughout the world. The most frequent destination is Western Europe, but a number of deliveries also head for North America and Asia.

Certificates: EN ISO 9001:2009
EN ISO 14001:2005
EN ISO 18001:2008
DIN 6701-2:2015 A3
EN 15085, CL1

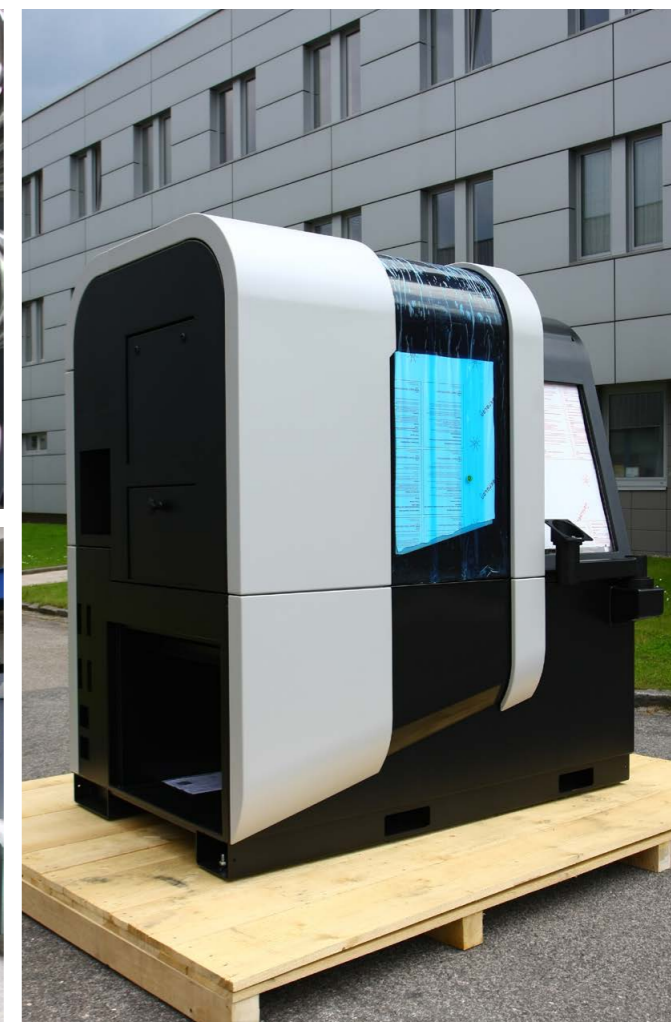

PRESSURE VESSELS MADE TO MEASURE

The Company's second premises is the Elektrárenská Street plant, which offers complete development and production of pressure and non-pressure vessels made of steel, stainless steel and aluminium. These activities meet the majority of current globally recognised standards, such as ASME, GOST, etc. This production plant, which was incorporated into the Company in 2011, represents the main development base of KASPER KOVO in terms of new orders and employment.

The plant is divided into three individual production sections that require separate material flow – separation of stainless steel and aluminium from the steel product range. Our technological equipment for pressure vessel production covers all necessary processes from bottom moulding and manual or semi-automated welding of vessels to a modern production line for surface finishing. All auxiliary, management and control processes are set-up to meet international pressure vessel manufacturing standards.

The Elektrárenská Street plant is certified in accordance with EN ISO standards, Rolling Stock Standards 15085 CL1, PED, ASME, GOST, DNV, Bureau Veritas, and shipping registers LR and ABS.

The main markets for pressure vessels consist of European companies, but a number of deliveries also head for Asia, former Soviet states and America.

Certificates: EN ISO 9001:2009
EN ISO 14001:2005
EN ISO 18001:2008
DIN 6701-2:2015 A3
EN 15085, CL1

KASPER KOVO S.R.O.

ADDRESS: Elektrárenská 322
541 03 Trutnov 3

TEL: +420 499 852 111
FAX: +420 499 827 115
E-MAIL: info@kasperkovo.cz

COMPANY ID: 46508465
TAX ID: CZ46508465
WEB: www.kasperkovo.cz



WOOD WITH STYLE



Ing. David Kasper,
CEO

Hundreds of roof trusses for houses, as well as a treetop nature trail or an unusual granite stone construction. For more than a quarter of a century, KASPER CZ has devoted itself to the carpentry trade, but in the most modern form. The Company produces and supplies all types of wooden load-bearing structures for houses, industrial buildings and various unconventional projects.

High-quality timber from Nordic countries is primarily used in its production processes. It seeks innovative solutions for the implementation of its activities, using modern machinery in new production halls. The Company effectively invests significant amounts into innovation which, together with a fair and professional approach to every order, is the primary reason why KASPER CZ is involved in many unique projects.

Indeed, it is currently one of the most sought-after suppliers of wooden structures in the Czech Republic. Whether it is a matter of tie beams with gang-nail plates, traditional roof trusses or structures made of glued laminated timber and load-bearing wall panels for wooden buildings, KASPER CZ is in demand. Some of the Company's recently implemented projects have even won significant awards for their outstanding concept and processing.

Between 2018 and 2020, the Company has built covered timber warehouses and a new hall for carpentry structures machined on CNC machines, as well as production of wall panels and surface finishing. In 2019, we commissioned a production line for making wood briquettes from waste products as part of our efforts to follow a path of environmental responsibility.

Certificates: QUALITY EN ISO 9001:2016
EMS EN ISO 14001:2016
OHSAS EN ISO 18001:2008

KASPER CZ S.R.O.

ADDRESS: Ječná 550
541 03 Trutnov 3

TEL: +420 499 827 300
FAX: +420 499 827 301
E-MAIL: podpora@kaspercz.cz

COMPANY ID: 25277839
TAX ID: CZ25277839
WEB: www.kaspercz.cz

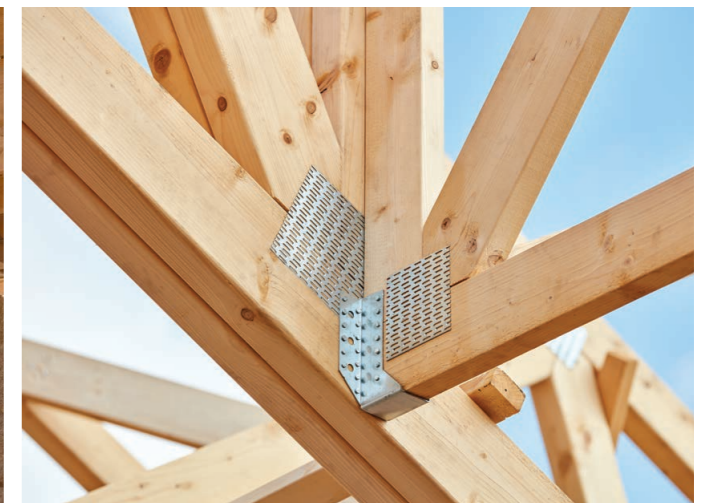



INTERNATIONAL BRANCHES OF KASPER CZ

The Company produces and supplies wooden load-bearing structures for customers from the Czech Republic, and also from Slovakia, Austria and Poland. In 1997, the Company founded its Polish branch KASPER Polska Sp. z o.o., before later establishing KASPER SK s.r.o. in the Slovakian town of Senec in 2015. Both companies design, manufacture and supply wooden structures to the mentioned markets.

KASPER SK S.R.O.

ADDRESS: Železničná 56
900 24 Senec
Slovenská republika

TEL: +421 948 258 382
E-MAIL: info@vaznikykasper.sk

COMPANY ID: 50028197
TAX ID: 2120149185
WEB: www.vaznikykasper.sk

KASPER POLSKA SP. Z O.O.

ADDRESS: ul. Metalowców 6
44-109 Gliwice
Polská republika

TEL: +48 32 270 45 08
FAX: +48 32 270 45 09
E-MAIL: biuro@kasperpolska.com

NIP: 631-20-53-647
REGION: 273492827



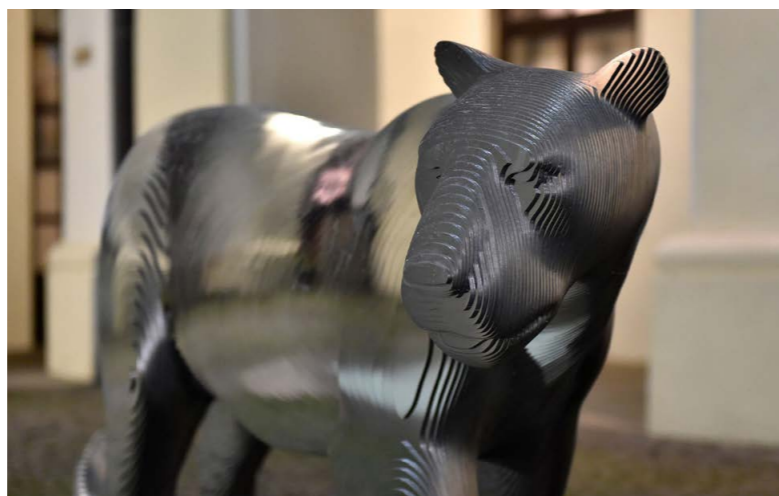

WORKS OF ART

In addition to industrial production, KASPER KOVO s.r.o. also works together with prominent artists.

Artistic works produced for our partners in the art sector are technologically designed in the form of sheet-metal structures or based on pressure vessels. The basic material is generally stainless steel.

KASPER[®]

KASPER GROUP



